



WHITTLEBURY
WEDDINGS

ASIAN WEDDINGS

ASIAN WEDDINGS

AT WHITTLEBURY PARK

WELCOME	01
CIVIL CEREMONIES	03
ROOM DECOR	05
EVENT CATERERS	07
RECOMMENDED CATERERS	07
THE ATRIUM 1905	09
RECOMMENDED SUPPLIERS	11
THE ORGANISERS	12
TERMS & CONDITIONS	13
DIRECTIONS	16

WELCOME

WELCOME TO WHITTLEBURY PARK WEDDINGS

With over 25 years' experience Whittlebury Park has hosted weddings, parties, and engagements for many different cultures and religions. We understand the decorum and needs to achieve your specific event requirements.

The Atrium, Whittlebury Park is set in 700 acres of rolling parkland and is one of the largest venue hire locations in South Northamptonshire. We're just 15-20 minutes from the M1 (j15a) and the M40 (j10), close to Milton Keynes, Bedford, Luton, Northampton, Coventry and Leicester.

With stunning views from the panoramic balconies that surround the building, the Atrium offers the perfect backdrop for your special day with plenty of photo opportunities both inside and outside.

Regularly hosting a wide range of Asian weddings, ceremonies and receptions, can seat up to 400 guests theatre style and is licensed to hold civil ceremonies.

Our wedding team boasts the experience and dedication to ensure your special day is unforgettable. If you would like to view the venue, please contact the wedding team to book an appointment. Email weddings@whittlebury.com, or phone 01327 850470.

Whittlebury Wedding Team

ASIAN WEDDINGS



CIVIL CEREMONIES

YOUR WEDDING CEREMONY

Whittlebury Park is licensed to conduct civil ceremonies in the Atrium, and will seat 400 guests, theatre style. If you choose to have a civil ceremony with us, you will need to contact the registrar's office to discuss availability of dates and fees.

Northamptonshire Registration Office
Tel: 0300 126 1000
registrationservice@northamptonshire.gov.uk

You will appreciate that if a registrar is not available on the time /day that you have requested then we are unable to do a civil ceremony. Whittlebury Park falls in to the Northamptonshire registration office so the registrar has to come from this office.

Included in our ceremony costs are:

- > Two rooms for the bridal party to use on the day for changing
- > Red carpet aisle and gold banqueting chairs with blue pads.

ASIAN WEDDINGS



ROOM DECOR



We have seven recommended suppliers of stage decor, who know Whittlebury Park well, and can advise you what fits and looks best in our venues. These companies are:

Eastern Touch
01582 752417
www.easterntouch.co.uk

Wed-In-Style
0800 0321611
www.wed-in-style.co.uk

Showcase Weddings
0800 5425168
www.showcaseweddings.co.uk

Swarg
07810 491613/ 07899 792060
www.swarg.co.uk

Guyatri Weddings & Events
07956 334271
www.guyatriweddings.com

Essential Couture
01923 775020
www.essentialcouture.co.uk

Dream Moments
07930 511212
www.dreammoments.co.uk

ROOM DECOR



The Atrium ceiling height is 2.90m. Please make your decorators aware of this when you're planning your event decor.

With ceremonies, Whittlebury Park is only responsible for supplying the chairs and tables required, and setting these out in accordance with the plan discussed by yourselves and your chosen decorators.

EVENT CATERERS

YOUR OWN CATERERS

When you choose to have your own caterers:

We will need to meet with them to see what they have promised you is practical and possible in our kitchens.

We will require a copy of the following:

1. Their food registration certificate
2. Public liability insurance certificate
3. Food hygiene rating no lower than 4

All certificates must be valid for the date of your wedding.

You will appreciate that as they are not familiar with our kitchens and venue, it is necessary to have a supervisor present from Whittlebury Park during the course of the day for Health & Safety reasons and to co-ordinate the day.

Table linen, crockery, cutlery and glasses is supplied by your caterers or hired in by them.

Recommended caterers

Greenleaf
0208 5747 779
www.greenleafservices.com

Sanjay Foods
01162 660777
www.sanjayfoods.com

Preeti Catering
0208 6060 303
www.preeticatering.co.uk

Mahirs Experience
0845 3908000/07507 884795
www.mahirs.com

Milans
01162 460136

We do welcome caterers who are not on our recommended list. However, there will be a damages bond. This bond is required to ensure full compliance with the terms & conditions of using our kitchens. These terms & conditions are available by request.

Please note that this bond must be paid separately and will be refunded 7 days after your event if your chosen caterers have fully complied with the terms & conditions.

ASIAN WEDDINGS



THE ATRIUM 1905

FIRST FLOOR

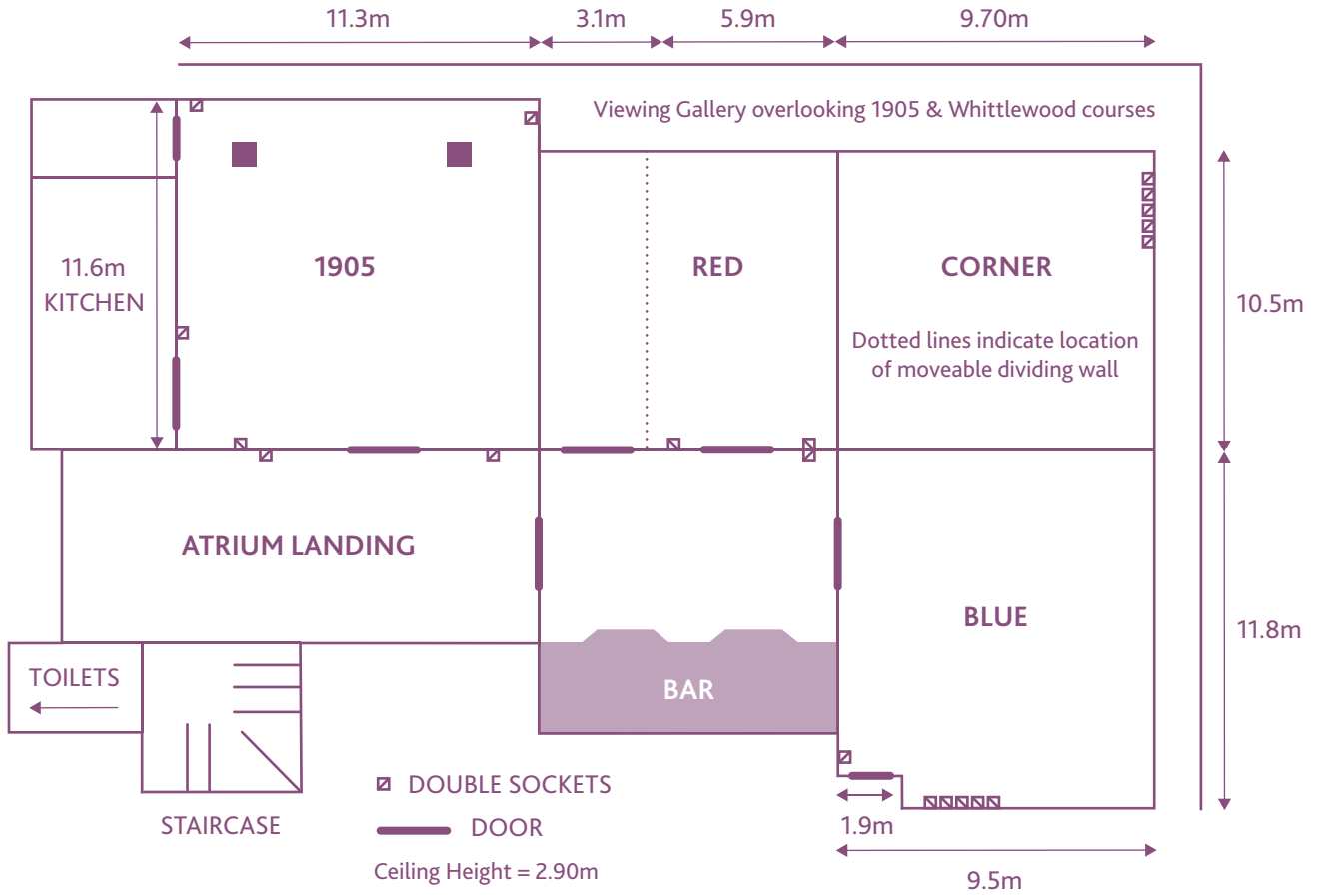

MANDAP LAYOUT WITH BUFFET LUNCH

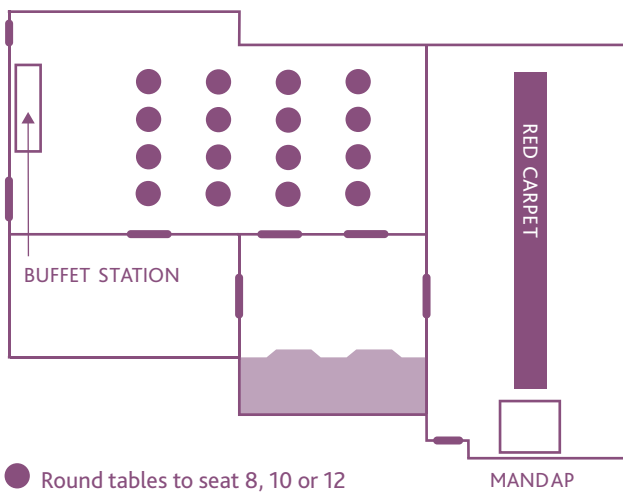

Moveable dance floor & staging available

EVENING RECEPTION LAYOUT

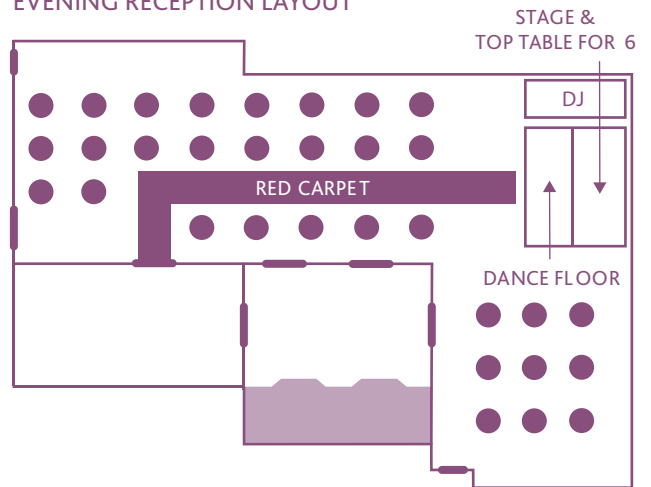

Moveable dance floor & staging available

THE ATRIUM 1905

FIRST FLOOR

MUSLIM SEGREGATED

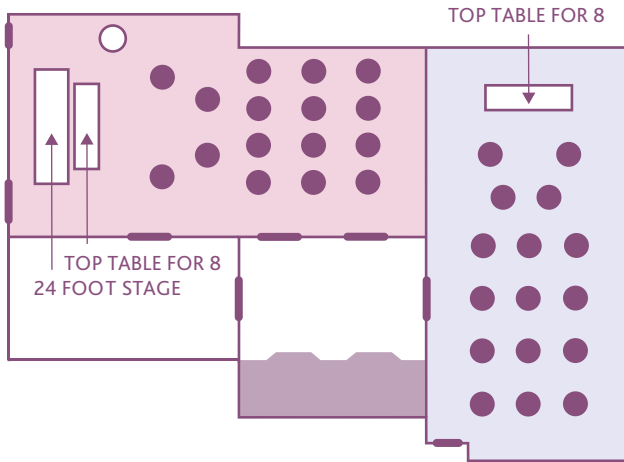

- Gift Table
- Round tables to seat 12
- Ladies section
- Mens section

MUSLIM NON-SEGREGATED

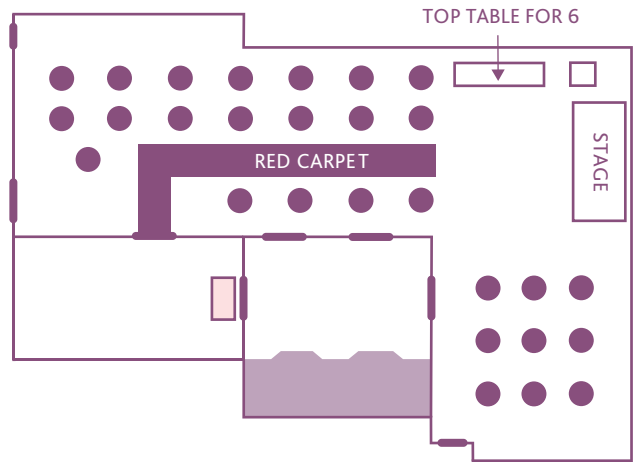

- Gift Table
- Round tables to seat 10
- Trestle table for drinks on arrival

ENGAGEMENT PARTY

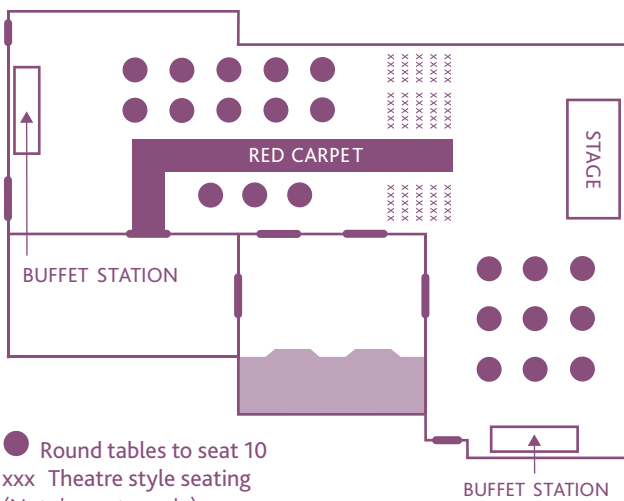

- Round tables to seat 10
- xxx Theatre style seating (Not drawn to scale)

SANJEE PARTY

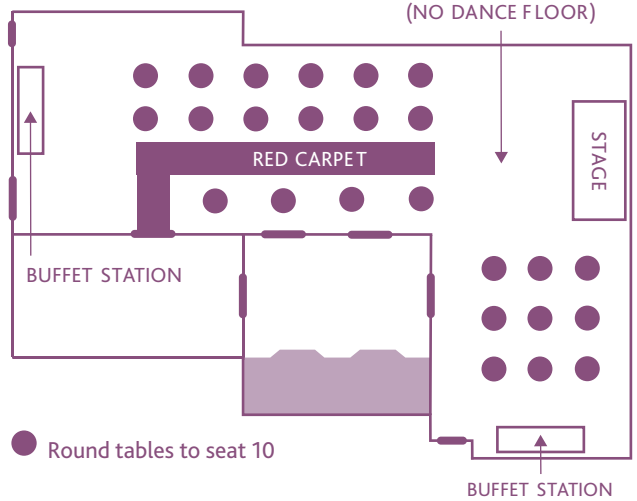

- Round tables to seat 10

RECOMMENDED SUPPLIERS

Hair & Make up

J Kang Beauty Academy
www.jkangbeautyacademy.co.uk
01604 583000/07879 674174

Nayna Beauty Essentials
e.naynam@hotmail.co.uk
07969 431679

Photographers

Apresh Chavda
www.apreshchavda.com
077477 77007

Kaushik Bathia Photography
www.kaushikbathia.com
07956 505383

Shital Gohil
www.shitalgohil.com
0208 9548848

Discos

Divine Musiq
www.divinemusiq.com
07949 241783 (Amit)

Funkasia
www.funkasia.co.uk
07968 449189

Enigma
www.enigma-events.co.uk
07974 075676

Event Management /Wedding Planning

Amore
www.amoreweddingsandevents.com
07939 318934

Enigma Events
www.enigma-events.co.uk

Lighting & AV Hire

Divine Musiq
www.divinemusiq.com
07949 241783(Amit)

VIP
www.indianweddingday.com
07885 7860

Ceremony Music

Shiv Gohil
www.indianweddingday.com
07885 786025

The Band Baja
www.thebandbaja.com
07505 120226

Dhol Players

Dhols Royce
www.dholsroyce.co.uk
07957 206860

GUPZ
07957 206860

The Band Baja
www.thebandbaja.com
07505 120226

Photobooths

Dotty Photography
www.dottyphotography.co.uk
07753 413434

Guest Factor
lee@theguestfactor.com
07970 618946

Ultimate Photobooth
info@ultimatephotobooth.co.uk
07956 505495

Wedding Stationary/Decor

Wedding Blossom
www.weddingblossom.co.uk
07753 413434

Beaulicious
info@beaulicious.co.uk
07984 355303

Quality Chair Covers
01908 968740
www.qualitychaircovers.co.uk

Furniture Hire

Somel Tent Hire
www.someltenthire.co.uk
0247 6639757

Event Solutions
Skippy
01327 860888

DIRECTIONS

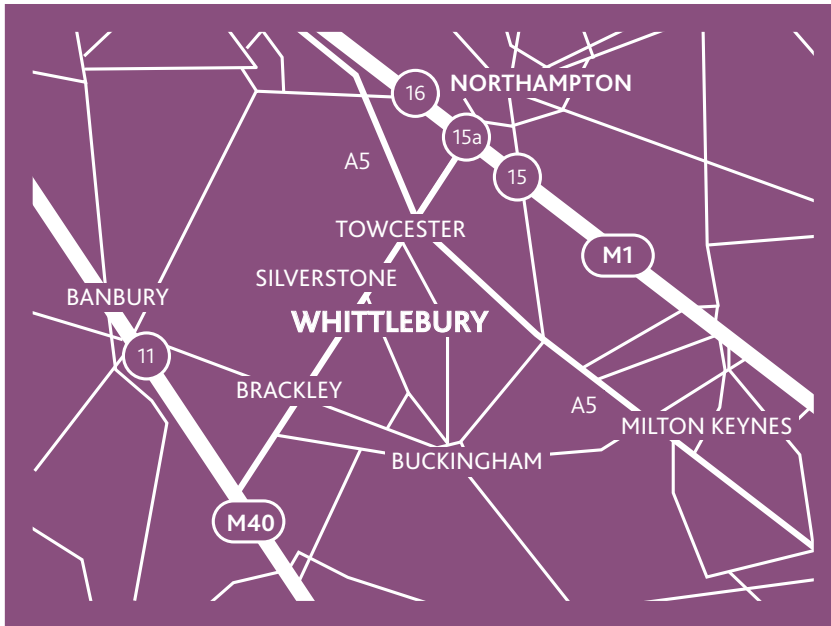

SatNav -
NN12 8QH

FROM NORTHAMPTON - Leave Northampton by 'Sixfields' on the A.43 heading towards Oxford / M.1 north Junction 15a - Then follow directions below.

FROM M.1 (Junction 15a) - Take the A43 towards Oxford – After 7 miles at Towcester straight over two roundabouts (past Macdonalds & BP garage on opposite side of the carriageway) – After 1 mile turn off slip road towards Buckingham & Whittlebury – At mini roundabout turn left onto the A.413 to Whittlebury - Keep on the main road straight through the village – After the last house of the right turn into the main entrance gates to Whittlebury Park.

FROM BLETCHLEY - Get onto the A.5D heading north towards Milton Keynes - Then follow directions below.

FROM MILTON KEYNES - Join the A.5D dual carriageway near the railway station heading north to Hinckley - At the Old Stratford roundabout take 3rd exit continuing north towards Towcester – go past the Paulerspury Shell garage - After 2 miles turn left for Whittlebury – After 2 miles at T junction Turn left onto the A.413 to Whittlebury - Keep on the main road straight through the village – After the last house of the right turn into the main entrance gates to Whittlebury Park.

FROM AYLESBURY & BUCKINGHAM - Go into Buckingham town centre - Head down hill past the 'Old Goal' (Castle on the left) – At the mini-roundabout Turn left onto the A.413 towards Maids Moreton (up the hill past Prezzo's restaurant) – Keep on the A.413 through Akeley village – After 4 miles there is a long straight into Whittlebury – Just after the 30mph sign turn left into the main entrance gates to Whittlebury Park.

FROM M.40 (JUNCTION 10) – Take the A.43 dual carriageway north towards Northampton - Go round Brackley (past BP garage on 7th roundabout) - After 5 miles go past the Green Man Pub – Take the next slip road off left to Silverstone – Go straight on through Silverstone – After 1 mile at mini roundabout turn right towards Whittlebury (small twisty road) – At the T junction in Whittlebury by the war memorial Turn right toward Buckingham - Keep on the main road straight through the village – After the last house of the right turn into the main entrance gates to Whittlebury Park.

Whittlebury Park is approximately 20 minutes from all places mentioned above

On arrival at **WHITTLEBURY PARK** – follow the signs from the Gatehouse.

THE PADDOCKS – turn right at the security gatehouse half way up drive.

THE ATRIUM – is the large white building on the left opposite the Hall.

PAVILION & ORANGERY – continue up the drive as far as you can go, passing the Atrium on the left. The Pavilion is adjacent to the cricket pitch, and The Orangery has a traditional turning circle entrance with a car park to its right.

WHITTLEBURY HALL – is the large red brick building opposite the Atrium. There is a drop off area to the right of the main drive and a separate car park on the right, just past the main building.

WHITTLEBURY
WEDDINGS

Whittlebury, Northamptonshire, NN12 8QH

01327 850470

weddings@whittlebury.com

whittlebury.com/weddings

REGIONAL
FINALIST



THE 2020
WEDDING
INDUSTRY AWARDS



PHOTOGRAPHY BY ADIMAD PRODUCTION